

04 Roof
1 : 100

-01 Substructure
1 : 50

EXTERNAL WALL

18mm Marmont Presto Thro' coloured render / NORCID Western Red Cedar board fixed to timber battens on Tyvek Supro breather membrane on external leaf 100mm dense concrete block (Thimco) with 100mm cavity fully filled with Xtratherm CTPR cavity insulation boards. Internal leaf 100mm insulation block (density 450-600kg/m³) throughout.
12.5mm plasterboard dot and dab dry lining.

OR

102.5mm brick facing (Bostok hatched Antique) with bedded flush mortar pointing 1:40. 100mm Stonecrete outer leaf stone finish, 100mm cavity fully filled with Xtratherm CTPR cavity insulation boards. Internal leaf 100mm insulation block (density 450-600kg/m³) throughout.
12.5mm plasterboard dot and dab dry lining on adhesive dabs.
All Blockwork in a type (S) or (M) mortar.

REFER TO FINISHES SCHEDULE AND/OR ELEVATIONS FOR CLARIFICATION OF MATERIAL LOCATIONS.

STANDARD STUDWORK INTERNAL PARTITION
One layer of 12.5mm plasterboard each side of 70mm metal studs / 25mm sound insulation quilt between studs above and below (min density 19 kg/m³).

BUTRESS STUDWORK WALL PARTITION
12.5mm plasterboard with joints taped and filled to both sides, 9.5mm ply sheathing to both sides, min 47x75 C16 timber studs @600mm centres, 25mm sound insulation quilt between studs (min density 19 kg/m³).

Threshold ACO Drain
Soil Pipe Connection
Movement Joint (positions to be approved by the Structural Engineer)
Sanitary Stack / Discharge Pipe (other Soil Vent Pipe or Air Admittance Valve as noted)

Cavity Barrier
Fire Stop
Consumer Unit / Smart meter
NTE
Network Termination Equipment

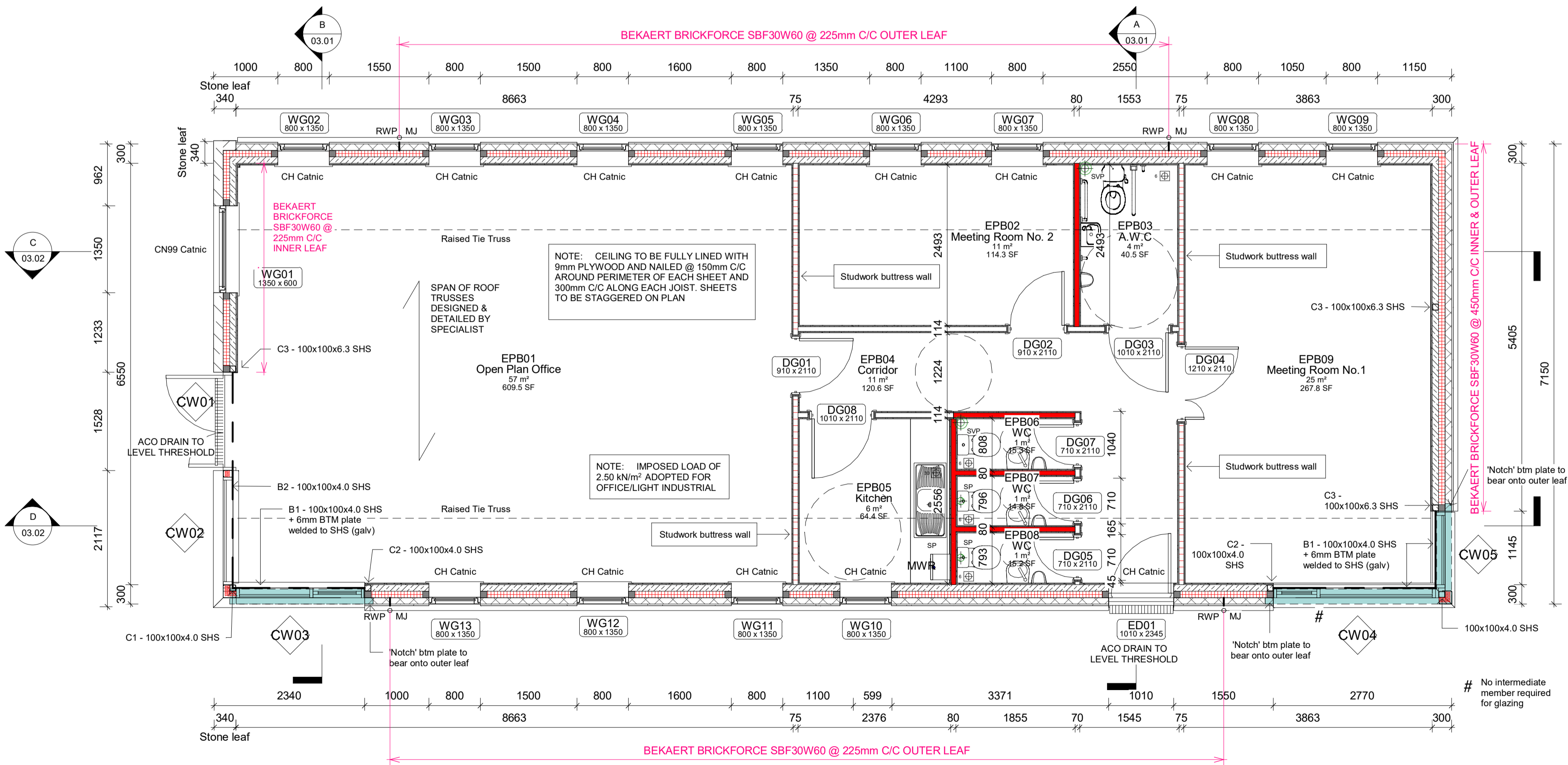

00 Ground Floor
1 : 50

Revision	Date	Comment	Author / Checked
I	21.01.20	Update to WG10	SAT /
H	13.12.19	Structural update	SAT /
G	09.12.19	Structural update	SAT /
F	02.12.19	Structural revision	SAT /
E	20.11.19	Structural revision	SAT /
D	01.11.19	Structural & elevational update	SAT /
C	06.06.17	Gable overhang and optional partitioning omitted	SAT /
B	15.05.17	Block hatch update	SAT /
A	24.03.17	Update to Client, specialist designer and Engineer's comments	SAT / GLP

Project Title
Kings Orchard, Stoke Gabriel

Detail
Employment Building - GA Plans

Project No.	Originator	Volume	Level	Type	Role	Number
12732EPB-LHC - 00	-GF - DR - A	-02.01				

Status
Construction Issue

Revision
October 2016

Scale
As indicated@A1

lhc architecture urbanism landscape

LHC GROUP
www.lhc.net

EXETER 01392 444334
PLYMOUTH 01752 669388

CONTRACTORS MUST CHECK ALL DIMENSIONS ON SITE - ONLY FIGURED DIMENSIONS ARE TO BE WORKED FROM - DISCREPANCIES MUST BE REPORTED TO THE ARCHITECT BEFORE PROCEEDING © THIS DRAWING IS COPYRIGHT